

**Performance Data - BAT Series**

Normal Performance Range			Typical Operating Point				
Model	CFM	Ps (mm)	CFM	Out. Vel. (m/s)	Ps (mm)	RPM	Shaft Power (hp)
7 x 7S	600-1100	15- 90	1000	9.8	50	1900	.62
9 x 7S	750-1400	15-100	1250	9.7	50	1478	.63
9 x 9S	1000-1750	15- 90	1600	9.7	50	1521	.81
10 x 8S	1000-1750	15-100	1600	9.9	50	1325	.76
10 x 10S	1200-2200	15- 90	2000	9.9	50	1326	1.00
12 x 9	1300-2400	20-100	2200	9.9	50	1142	1.05
12 x 12	1700-3100	20- 80	2800	9.8	50	1167	1.38
15 x 11	2000-3500	20- 90	3200	10	50	910	1.54
15 x 15	2500-4400	20- 75	4000	9.9	50	967	1.98
18 x 13	2600-4700	20- 90	4300	9.9	50	767	2.00
18 x 18	3400-6100	20- 85	5600	9.9	50	794	2.64

**Fan Rotation & Orientation**

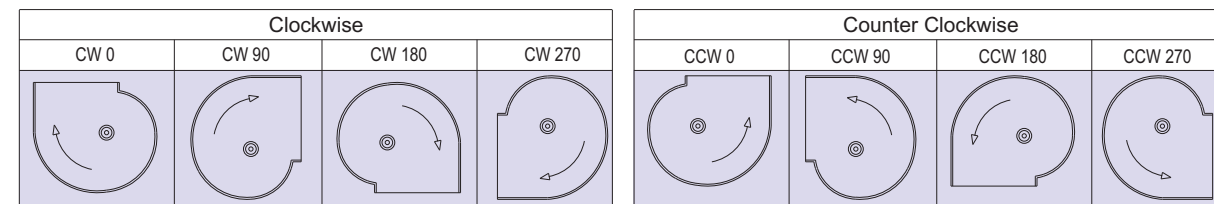

Rotation is determined from the drive (motor) side of the fan



The Company's 20,000 sq. ft. plant in NOIDA, near New Delhi incorporates state of the art equipment and machinery.

**BLOWTECH AIR DEVICES PVT. LTD.**

(An ISO 9001-2000 Certified Company)

A-15, Sector-65, Noida (U.P.), India

Tel. ++91-120-4229300 (4 Lines) Fax ++91-120-4229309

e-mail : [blowtech@airtelmail.in](mailto:blowtech@airtelmail.in) web : [www.blowtechair.com](http://www.blowtechair.com)

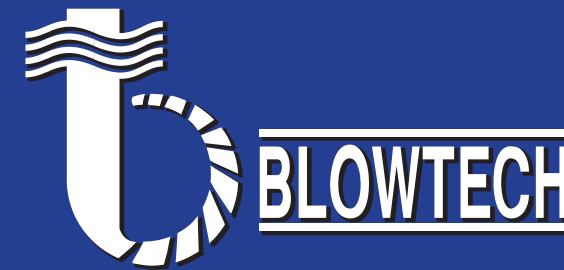

**DOUBLE INLET CENTRIFUGAL FANS**

(Forward Curved, Belt Driven)

**BAT** Series

**FBD** Series (Square Outlet Metric Size)

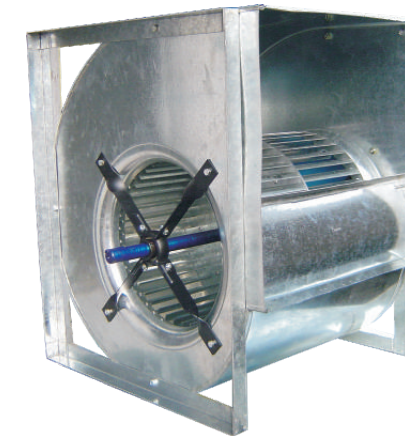

FBD R



FBD K



BAT S



BAT

**"FAN-TA-SIZE" Computerized Optimal Fan Selection Program**

This sophisticated Windows based fan selection program automatically provides the best selection of BLOWTECH fans for a given requirement of air volume and pressure. It gives all the desired operating point parameters such as fan speed, fan power, motor power, outlet velocity, efficiency, etc. in a fraction of a second. No need now for voluminous fan performance data and approximate and laborious extrapolation methods for fan selection and operating point determination.



## BLOWTECH DOUBLE INLET CENTRIFUGAL FANS

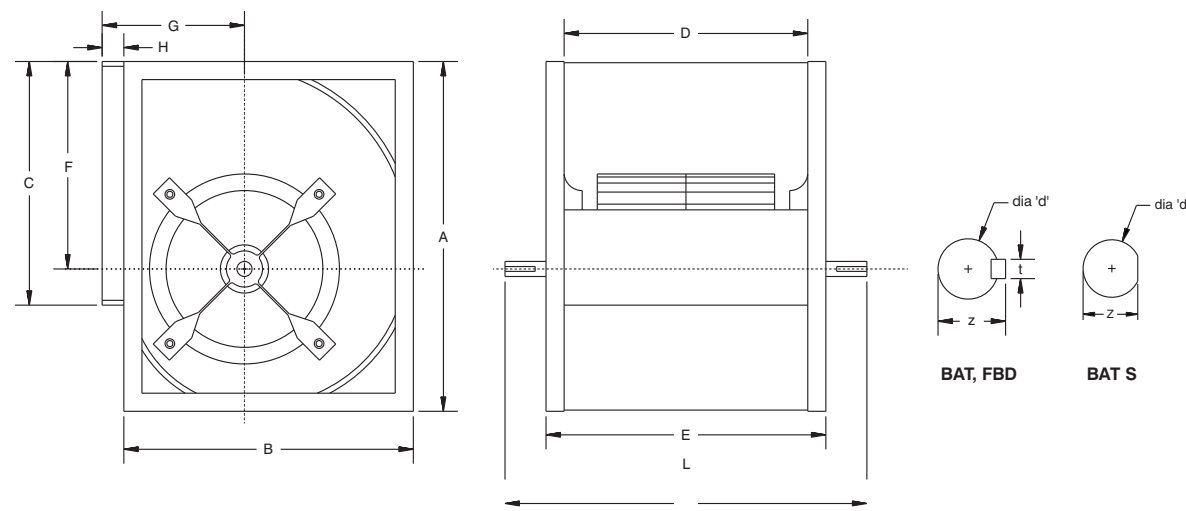

**Dimensions - FBD Series**

Model	A	B	C	D	E	F	G	H	L	d	t	z
FBD 250 R	460	384	322	322	372	272	195	35	480	20	6	22.5
FBD 280 R	518	432	360	360	420	304	215	35	550	25	8	28
FBD 315 R	580	480	404	404	464	342	236	38	600	25	8	28
FBD 355 R	654	542	453	453	534	385	261	36	665	30	8	33
FBD 400 R	730	606	506	506	586	432	290	40	725	30	8	33
FBD 450 R	830	680	569	569	649	487	322	45	815	30	8	33
FBD 500 R	918	750	638	638	718	540	352	50	875	35	10	38
FBD 560 R	1030	845	715	715	815	605	390	48	1000	40	12	43
FBD 630 R	1158	946	800	800	900	680	434	53	1090	40	12	43
FBD 710 K	1303	1061	898	898	998	765	485	60	1255	50	14	53.5
FBD 800 K	1468	1181	1007	1007	1107	862	540	74	1350	50	14	53.5
FBD 900 K	1648	1311	1130	1130	1230	971	604	97	1520	60	18	64
FBD 1000 K	1810	1450	1267	1267	1367	1066	657	90	1660	60	18	64

All dimensions are in mm

**Dimensions - BAT Series**

Model	A	B	C	D	E	F	G	H	L	d	t	z
7x 7 S	330	316	208	232	282	186	153	-	330	20	-	19
9x 7 S	390	380	262	232	282	215	185	-	330	20	-	19
9x 9 S	390	380	262	298	348	215	185	-	395	20	-	19
10x 8 S	446	425	289	265	315	249	203	-	360	20	-	19
10x 10 S	446	425	289	331	381	249	203	-	430	20	-	19
12x 9	525	455	341	309	369	294	230	38	495	25	8	28
12x 12	525	455	341	395	455	294	230	38	585	25	8	28
15x 11	620	538	404	373	453	342	264	36	585	25	8	28
15x 15	620	538	404	471	551	342	264	36	685	25	8	28
18x 13	745	650	478	430	510	415	314	36	665	25	8	28
18x 18	745	650	478	557	637	415	314	36	790	25	8	28

All dimensions are in mm

Note – Fan sizes 7x7 to 10x10 are provided with mounting feet (not rectangular side frames).

### Salient Technical Features :

The **Blower Wheel** is made from high quality rust resistant galvanized sheet steel and has forward curved blades. A large forged steel or die cast aluminium hub with a precisely machined bore and a keyway is fitted to the wheel backplate. Use of precision tooling for the punching and assembling of wheel components results in extremely low levels of eccentricity and run out . The wheel is statically and dynamically balanced to balance quality grade G 6.3 of ISO 1940 standard.

The **Fan Housing** is also made from high quality rust resistant galvanized sheet steel with the housing wrapper fixed to the side plates using 'Pittsburg Lock'. Side plate profiles are precision cut for proper centering of the Impeller - Shaft assembly and accurate overall fan dimensions. Aerodynamically shaped inlet venturies form an integral part of the side plates in BAT & FBD R models.

The **Fan Shaft** is manufactured from high quality EN9 carbon steel with keyways at both ends (for pulleys) and the centre (for wheel hub) and is ground to close tolerance for precision fit.

The **Wheel - Shaft Assembly** is supported at both ends in very high quality imported pre-greased permanently sealed ball bearings with an eccentric locking collar. In BAT & FBD R models, each bearing sits inside a moulded rubber housing which in turn is mounted on to the fan housing using a set of 4 specially designed die - formed epoxy powder coated sheet steel brackets on each side. After assembly, the shaft is coated with a fine layer of anti-corrosion laquor.

**Rectangular Side Frames** made from G.I. sheets are bolted to the Fan Housing. This improves Fan rigidity and strength and allows easy mounting of the fan in various orientations. BAT S fans are provided with mounting feet.

In FBD K models, Side Frames are made of welded heavy gauge mild steel sections. The Wheel-Shaft assembly is supported in self-aligning bearing pillow blocks which are mounted on the steel side frames.

**Performance Data - FBD Series**

Model	Normal Performance Range		Typical Operating Point				
	CFM	Ps (mm)	CFM	Out. Vel. (m/s)	Ps (mm)	RPM	Shaft Power (hp)
FBD 250 R	1250-2300	15-100	2100	9.6	50	1455	1.20
FBD 280 R	1600-3000	15-100	2700	9.8	50	1290	1.48
FBD 315 R	2000-3700	15-100	3400	9.8	50	1163	1.83
FBD 355 R	2500-4600	15-100	4200	9.7	50	1015	2.20
FBD 400 R	3200-5800	15-100	5300	9.8	50	932	2.74
FBD 450 R	4100-7500	15-100	6800	9.9	50	802	3.52
FBD 500 R	5200-9500	15-100	8500	9.9	50	704	4.37
FBD 560 R	6300-12000	15-100	10500	9.7	50	626	5.35
FBD 630 R	8000-15000	15-100	13200	9.7	50	558	6.54
FBD 710 K	10000-19000	15-100	17000	9.9	50	492	8.31
FBD 800 K	12500-24000	15-100	21000	9.8	50	436	10.04
FBD 900 K	16000-30000	15-100	26500	9.8	50	391	12.80
FBD 1000 K	20000-38000	15-100	33500	9.8	50	347	15.97