



Single Piece Small Fan Blades (Series- F)

Material - Aluminium Sheet

Rotation - Looking at the Fan from Air Discharge Side

Cat.No.	Diameter D	Blades	Pitch (Degree)	H(+1,-1)	h(+2,-2)	Thickness (t)	Rotation
5F060-22C 5F060-28C 5F060-34C	154	5	22	25	13	0.85	CW
		5	28	31	15	0.85	CW
		5	34	37	19	0.85	CW
5F070-22C 5F070-28C 5F070-34C	172	5	22	28	14	0.85	CW
		5	28	34	17	0.85	CW
		5	34	41	21	0.85	CW
5F080-22C 5F080-28C 5F080-34C	199	5	22	29	14	0.85	CW
		5	28	37	18	0.85	CW
		5	34	43	22	0.85	CW
5F090-22C 5F090-28C 5F090-34C	229	5	22	33	16	1.00	CW
		5	28	41	21	1.00	CW
		5	34	49	25	1.00	CW
5F0100-22C 5F0100-28C 5F0100-34C	254	5	22	37	18	1.00	CW
		5	28	45	21	1.00	CW
		5	34	52	26	1.00	CW

All Dimensions are in mm.

Fan Blades can also be supplied in CCW rotation.

Catalogue Numbering system

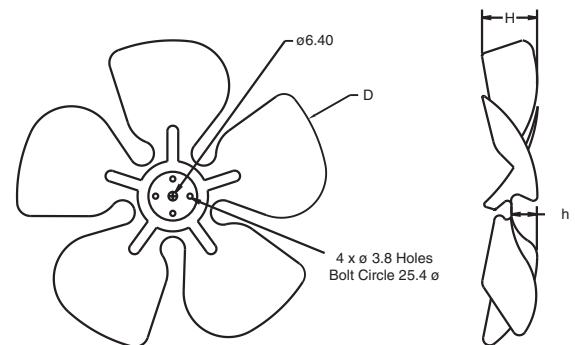
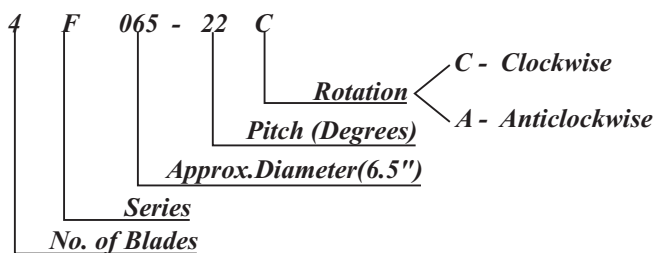

BLOWTECH AIR DEVICES PVT. LTD.

(An ISO 9001-2000 Certified Company)

A-15, Sector-65, Noida (U.P.), India

Tel. ++91-120-4229300 (4 Lines) Fax ++91-120-4229309

e-mail : blowtech@airtelmail.in web : www.blowtechair.com



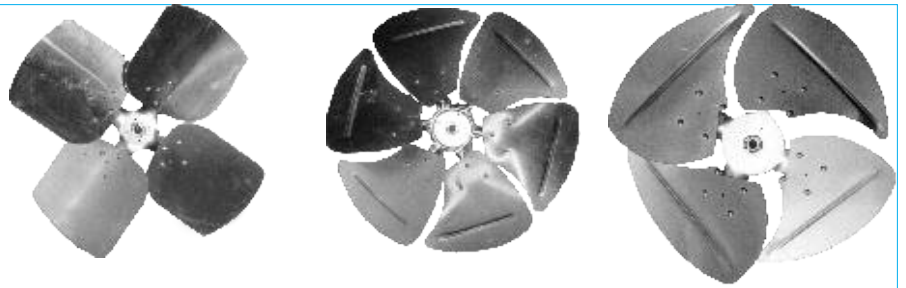

Aluminium Fan Blades with steel spider (Propeller Type) (Series -P)

- Material Blades - Aluminium Sheet
 Spider - Zinc Plated C.R.C Sheet
 Hub - Zinc Plated M.S
 Socket Set Screw - M8
 Rotation - Looking at the Fan from Air Discharge Side

Cat.No.	Blade dia. (D)	Pitch (Degree)	Height (H)	h	b	Bore	Blades	Rotation
6P115-40C*	287	40	95	42	20	12.7	6	CW
6P140-31C	356	31	80	45	24	12.7	6	CW
4P160-20C	406	20	90	46	24	12.7	4	CW
4P180-22C	452	22	110	53	24	12.7	4	CCW
6P180-24C	456	24	90	46	24	12.7	6	CW
4P200-34C	510	34	125	37	24	12.7	4	CCW
4P200-26C	510	26	98	51	24	12.7	4	CCW
4P220-23C	560	23	98	40	32	19	4	CW
4P220-27C	560	27	113	45	32	19	4	CW
4P220-33C	560	33	136	55	32	19	4	CW
4P240-23C	610	23	98	40	32	19	4	CW
4P240-27C	610	27	113	45	32	19	4	CW
4P240-33C	610	33	136	55	32	19	4	CW
4P260-23C	660	23	98	40	32	19	4	CW
4P260-27C	660	27	113	45	32	19	4	CW
4P260-33C	660	33	136	55	32	19	4	CW

All Dimensions are in mm.

Fan Blades can also be supplied in CCW rotation.

* Fan Blade is without steel spider.

Catalogue Numbering system

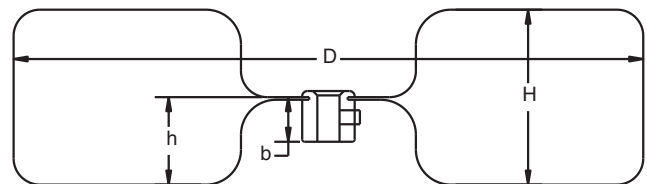
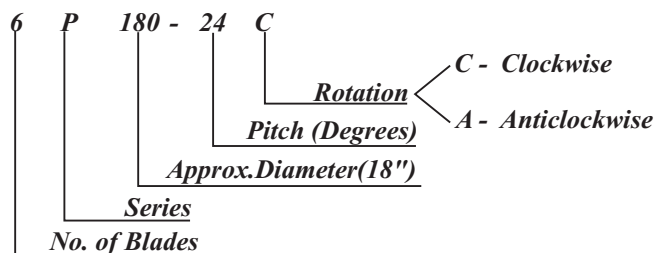

BLOWTECH AIR DEVICES PVT. LTD.

(An ISO 9001-2000 Certified Company)

A-15, Sector-65, Noida (U.P.), India

Tel. ++91-120-4229300 (4 Lines) Fax ++91-120-4229309

e-mail : blowtech@airtelmail.in web : www.blowtechair.com





Single Inlet Blower Wheels (Aluminium) (Series-S)

- Material - Wheel - Aluminium Sheet
 Hub - Aluminium Die Cast
 Socket Set Screw - M8
 Rotation - Looking at the wheel from the Air intake Side

Cat.No.	Dia. (D)	Height (H)	d	h	Blades	Bore
S060-29-015 S060-29-020 S060-29-025 S060-29-030 S060-29-032 S060-29-035	150	43 55 66 78 86 95	122	32	29	12.7
S065-36-015 S065-36-020 S065-36-025 S065-36-030 S065-36-032 S065-36-035	163	43 55 66 78 86 95	133	32	36	12.7
S070-36-020 S070-36-025 S070-36-030 S070-36-032 S070-36-035 S070-36-040 S070-36-045	181	55 66 78 86 95 104 117	153	32	36	12.7
S080-40-025 S080-40-030 S080-40-032 S080-40-035 S080-40-040 S080-40-045	196	66 78 86 95 104 117	169	32	40	12.7

Catalogue Numbering system

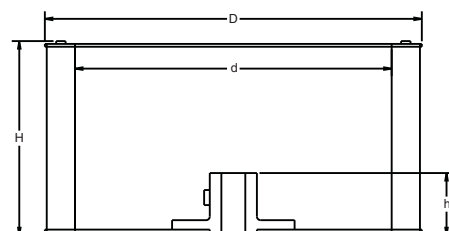
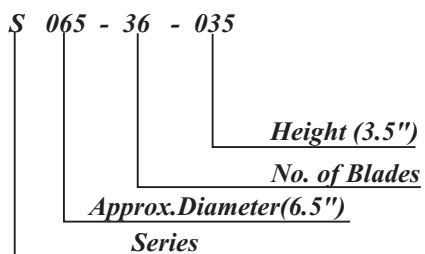

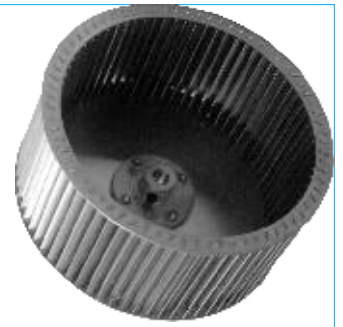

Cat.No.	Dia. (D)	Height (H)	d	h	Blades	Bore
S085-36-030 S085-36-032 S085-36-035 S085-36-040 S085-36-045 S085-36-050	218	78 86 95 104 117 129	189	32	36	12.7
S085-40-030 S085-40-035 S085-40-040 S085-40-050	218	80 95 106 129	178	32	40	12.7
S0105-48-035	272	96	228	50	48	12.7

All Dimensions are in mm.
Other Heights also available.

Catalogue Numbering system

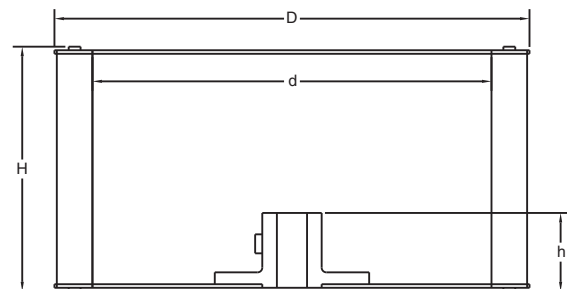
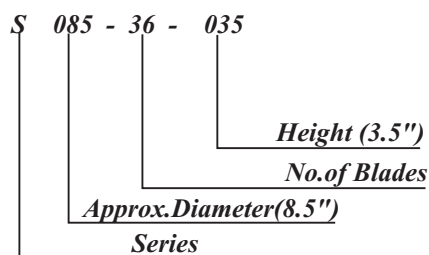

BLOWTECH AIR DEVICES PVT. LTD.

(An ISO 9001-2000 Certified Company)

A-15, Sector-65, Noida (U.P.), India

Tel. ++91-120-4229300 (4 Lines) Fax ++91-120-4229309

e-mail : blowtech@airtelmail.in web : www.blowtechair.com



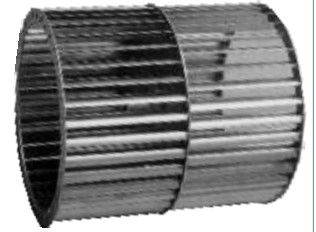

Double Inlet Blower Wheels (Aluminium) (Series-D)

Material Wheel - Aluminium Sheet
 Hub - Aluminium Die Cast

Socket Set Screw - M8

Cat.No.	Dia. (D)	Height (H)	d	h1	h2	Blades	Bore
D060-29-030 D060-29-040 D060-29-050 D060-29-060 S060-29-065 D060-29-070 D060-29-080 D060-29-090	150	83 107 129 153 167 185 205 228	122	25	18	29	12.7
D065-36-030 D065-36-040 D065-36-050 D065-36-060 S065-36-065 D065-36-070 D065-36-080	163	83 107 129 153 167 185 205	133	25	18	36	12.7
D070-36-040 D070-36-050 D070-36-060 D070-36-070 D070-36-080 D070-36-090	181	107 129 153 167 185 205 228	153	25	18	36	12.7

Catalogue Numbering system

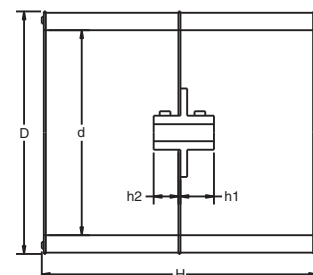
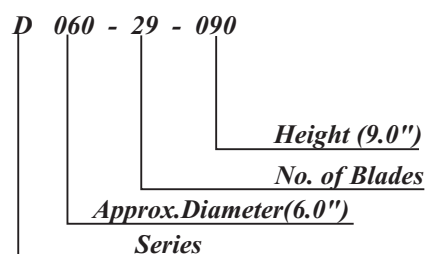

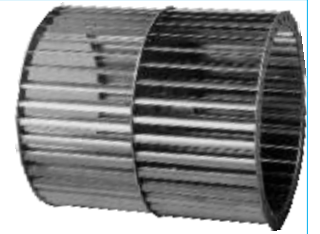

Cat.No.	Dia. (D)	Height (H)	d	h1	h2	Blades	Bore
D080-40-050 D080-40-060 D080-40-070 D080-40-080 D080-40-090 D080-40-100	196	129 153 185 205 228 256	169	25	18	40	12.7
D085-72-060 D085-72-070 D085-72-080 D085-72-090 D085-72-100	218	156 188 205 231 259	189	29	20	36	12.7
D085-40-060 D085-40-070 D085-40-080 D085-40-100	218	159 188 212 254	178	29	20	40	12.7

Cat.No.	Dia. (D)	Height (H)	d	h1	Blades	Bore
D080-38-080 D080-38-100	200 200	200 254	163 163	35 35	38 38	12.7 12.7
D090-42-080 D090-42-010 D090-42-010 D090-38-070 D090-38-090	225 225 225 242 242	200 250 260 172 234	188 188 188 193 193	35 35 35 50 50	42 42 42 38 38	12.7 12.7 12.7 12.7 12.7
D010-42-090 D010-42-010	280 280	234 260	231 231	50 50	42 42	12.7 12.7
D012-38-012	315	300	255	40	38	12.7

BLOWTECH AIR DEVICES PVT. LTD.

(An ISO 9001-2000 Certified Company)

A-15, Sector-65, Noida (U.P.), India

Tel. ++91-120-4229300 (4 Lines) Fax ++91-120-4229309

e-mail : blowtech@airtelmail.in web : www.blowtechair.com

